

For Consideration By	Licensing Sub-Committee
Meeting Date	22 February 2024
Type of Application	Vary a Premises Licence
Address of Premises	Dalston Corner, 1 Stoke Newington Road, London, N16 8BH
Classification	Decision
Ward(s) Affected	Shacklewell
Group Director	Rickardo Hyatt

1. **Summary**

- 1.1. This is an application to vary a premises licence to allow authorisation:
- To extend hours for supply of alcohol (off-sales)

2. **Application**

- 2.1. Mr Mehmet Annak has made an application to vary a premises licence under section 34 of the Licensing Act 2003.
- 2.2. The applicant is seeking authorisation for the following proposed variation:

Supply of Alcohol (Off-sales)	Standard Hours: Mon 08:00-03:00 Tue 08:00-03:00 Wed 08:00-03:00 Thu 08:00-03:00 Fri 08:00-03:00 Sat 08:00-03:00 Sun 08:00-03:00
The opening hours of the premises	Standard Hours: Mon 08:00-03:00 Tue 08:00-03:00 Wed 08:00-03:00

	Thu 08:00-03:00 Fri 08:00-03:00 Sat 08:00-03:00 Sun 08:00-03:00
--	--

2.3. The application is attached as Appendix A. The applicant has not specified any additional measures that could be converted to conditions to be applied to the licence.

3. **Current Status/History**

3.1. The current premises licence was granted by the Licensing Sub-Committee on 17 August 2023 (attached as Appendix D).

3.2. Temporary event notices have given in last twelve months at this premises as follows:

<u>Date of the event(s)</u>	<u>Hours</u>
17/11/2023-19/11/2023	23:00-03:00
24/11/2023-26/11/2023	23:00-03:00
01/12/2023-03/12/2023	23:00-03:00
08/12/2023-10/12/2023	23:00-03:00
15/12/2023-17/12/2023	23:00-03:00
22/12/2023-24/12/2023	23:00-03:00
29/12/2023-02/01/2024	23:00-03:00

4. **Representations: Responsible Authorities**

From	Details
Environmental Health Authority (Environmental Protection)	Have confirmed no representation on this application
Environmental Health Authority (Environmental Enforcement)	No representation received
Environmental Health Authority (Health & Safety)	No representation received
Weights and Measures (Trading Standards)	No representation received
Planning Authority	No representation received
Area Child Protection Officer	No representation received
Fire Authority	Have confirmed no representation on this application
Police (Appendix B1)	Representation received on the grounds of The Prevention of Crime and Disorder and Prevention of Public Nuisance
Licensing Authority (Appendix B2)	Representation received on the grounds of The Prevention of Crime and Disorder and Prevention of Public Nuisance
Health Authority	No representation received

5. **Representations: Other Persons**

From	Details
One representation received from and on behalf of local residents. (Appendix C)	Representation received on the grounds of The Prevention of Crime and Disorder, Public Safety, Prevention of Public Nuisance and The Protection of Children from Harm.

6. **Guidance Considerations**

- 6.1. The Licensing Authority is required to have regard to any guidance issued by the Secretary of State under the Licensing Act 2003.

7. **Policy Considerations**

- 7.1. Licensing Sub-Committee is required to have regard to the London Borough of Hackney's Statement of Licensing Policy ("the Policy") adopted by the Licensing Authority.
- 7.2. The Policy applies to applications where relevant representations have been made. With regard to this application, policies, LP1 (General Principles), LP2 (Licensing Objectives), LP3 (Core Hours) and LP4 ('Off' Sale of Alcohol) are relevant.

8. **Officer Observations**

- 8.1. If the Sub-Committee is minded to approve the application, the following additional conditions should be applied the licence:
- None.

9. **Reasons for Officer Observations**

- 9.1. No conditions have been proposed by the applicant and responsible authorities.

10. **Legal Comments**

- 10.1. The Council has a duty as a Licensing Authority under the Licensing Act 2003 to carry out its functions with a view to promoting the following 4 licensing objectives;
- The Prevention of Crime and Disorder
 - Public Safety
 - Prevention of Public Nuisance
 - The Protection of Children from Harm
- 10.2. It should be noted that each of the licensing objectives have equal importance and are the only grounds upon which a relevant representation can be made and for which an application can be refused or terms and conditions attached to a licence.

11. **Human Rights Act 1998 Implications**

- 11.1. There are implications to;
- **Article 6** – Right to a fair hearing
 - **Article 14** – Not to discriminate
 - Balancing: **Article 1**- Peaceful enjoyment of their possession (i.e. a licence is defined as being a possession) with **Article 8** – Right of Privacy (i.e. respect private & family life) to achieve a proportionate decision having regard to the protection of an individuals rights against the interests of the community at large.

12. **Members Decision Making**

12.1. **Option 1**

That the application be refused

12.2. **Option 2**

That the application be approved, together with any conditions or restrictions which Members consider necessary for the promotion of the Licensing objectives.

13. **Conclusion**

- 13.1. That Members decide on the application under the Licensing Act 2003.

Appendices:

Appendix A: Application for a premises licence and supporting documents

Appendix B: Representations from responsible authorities

Appendix C: Representations from other persons

Appendix D: Current premises licence

Appendix E: Location map

Background documents

Licensing Act 2003

LBH Statement of Licensing Policy

Report Author	Name: Shan Uthayasangar Title: Licensing Officer Email: Shan.Uthayasangar@hackney.gov.uk Tel: 02083562431
Comments for the Group Director of Finance and Corporate Resources prepared by	Name Title Email Tel

APPENDIX A

Hackney

LA07

Application to vary a premises licence under the Licensing Act 2003

PLEASE READ THE FOLLOWING INSTRUCTIONS FIRST

Before completing this form please read the guidance notes at the end of the form. If you are completing this form by hand please write legibly in block capitals. In all cases ensure that your answers are inside the boxes and written in black ink. Use additional sheets if necessary.

You may wish to keep a copy of the completed form for your records.

I/We Ms Mehmet Annak

(Insert name(s) of applicant)

being the premises licence holder, apply to vary a premises licence under section 34 of the Licensing Act 2003 for the premises described in Part 1 below

Premises licence number

PREM/2023/0046

Part 1 – Premises Details

Postal address of premises or, if none, ordnance survey map reference or description

Dalston Corner
1 Stoke Newington Road
Hackney

Post town

London

Postcode

N16 8BH

Telephone number at premises (if any)

Non-domestic rateable value of premises

£25250

Part 2 – Applicant details

Daytime contact telephone number

E-mail address (optional)

Current postal address if different from premises address

Post town		Postcode	
-----------	--	----------	--

Part 3 – Variation

Please tick as appropriate
Do you want the proposed variation to have effect as soon as possible? <input checked="" type="checkbox"/> Yes <input type="checkbox"/> No

If not, from what date do you want the variation to take effect?

DD	MM	YYYY

Do you want the proposed variation to have effect in relation to the introduction of the late night levy? (Please see guidance note 1) Yes No

<p>Please describe briefly the nature of the proposed variation (Please see guidance note 2)</p> <p>In order to extend the hours of licensable activities as:</p> <p>Sale of Alcohol consumption OFF the Premise: Monday to Sunday from 08:00 to 03:00 following day</p> <p>Opening Hours Monday to Sunday from 08:00 to 03:00 following day</p>

If your proposed variation would mean that 5,000 or more people are expected to attend the premises at any one time, please state the number expected to attend:

--

Part 4 Operating Schedule

Please complete those parts of the Operating Schedule below which would be subject to change if this application to vary is successful.

- | Provision of regulated entertainment (Please see guidance note 3) | Please tick all that apply |
|---|-------------------------------------|
| a) plays (if ticking yes, fill in box A) | <input type="checkbox"/> |
| b) films (if ticking yes, fill in box B) | <input type="checkbox"/> |
| c) indoor sporting events (if ticking yes, fill in box C) | <input type="checkbox"/> |
| d) boxing or wrestling entertainment (if ticking yes, fill in box D) | <input type="checkbox"/> |
| e) live music (if ticking yes, fill in box E) | <input type="checkbox"/> |
| f) recorded music (if ticking yes, fill in box F) | <input type="checkbox"/> |
| g) performances of dance (if ticking yes, fill in box G) | <input type="checkbox"/> |
| h) anything of a similar description to that falling within (e), (f) or (g) (if ticking yes, fill in box H) | <input type="checkbox"/> |
| Provision of late night refreshment (if ticking yes, fill in box I) | <input type="checkbox"/> |
| Supply of alcohol (if ticking yes, fill in box J) | <input checked="" type="checkbox"/> |

In all cases complete boxes K, L and M

A

Plays Standard days and timings (please read guidance note 8)			Will the performance of a play take place indoors or outdoors or both – please tick (please read guidance note 4)	Indoors	<input type="checkbox"/>
				Outdoors	<input type="checkbox"/>
Day	Start	Finish		Both	<input type="checkbox"/>
Mon			Please give further details here (please read guidance note 5)		
Tue					
Wed			State any seasonal variations for performing plays (please read guidance note 6)		
Thur					
Fri			Non-standard timings. Where you intend to use the premises for the performance of plays at different times to those listed in the column on the left, please list (please read guidance note 7)		
Sat					
Sun					

B

Films Standard days and timings (please read guidance note 8)			Will the exhibition of films take place indoors or outdoors or both – please tick (please read guidance note 4)	Indoors	<input type="checkbox"/>
				Outdoors	<input type="checkbox"/>
				Both	<input type="checkbox"/>
Day	Start	Finish	Please give further details here (please read guidance note 5)		
Mon					
Tue			State any seasonal variations for the exhibition of films (please read guidance note 6)		
Wed					
Thur			Non-standard timings. Where you intend to use the premises for the exhibition of films at different times to those listed in the column on the left, please list (please read guidance note 7)		
Fri					
Sat					
Sun					

C

Indoor sporting events Standard days and timings (please read guidance note 8)			Please give further details (please read guidance note 5)
Day	Start	Finish	
Mon			State any seasonal variations for indoor sporting events (please read guidance note 6)
Tue			
Wed			Non-standard timings. Where you intend to use the premises for indoor sporting events at different times to those listed in the column on the left, please list (please read guidance note 7)
Thur			
Fri			
Sat			
Sun			

D

Boxing or wrestling entertainments Standard days and timings (please read guidance note 8)			Will the boxing or wrestling entertainment take place indoors or outdoors or both – please tick (please read guidance note 4)	Indoors	<input type="checkbox"/>
				Outdoors	<input type="checkbox"/>
				Both	<input type="checkbox"/>
Day	Start	Finish	Please give further details here (please read guidance note 5)		
Mon					
Tue			State any seasonal variations for boxing or wrestling entertainment (please read guidance note 6)		
Wed					
Thur			Non-standard timings. Where you intend to use the premises for boxing or wrestling entertainment at different times to those listed in the column on the left, please list (please read guidance note 7)		
Fri					
Sat					
Sun					

E

Live music Standard days and timings (please read guidance note 8)			Will the performance of live music take place indoors or outdoors or both – please tick (please read guidance note 4)	Indoors	<input type="checkbox"/>
				Outdoors	<input type="checkbox"/>
				Both	<input type="checkbox"/>
Day	Start	Finish	Please give further details here (please read guidance note 5)		
Mon					
Tue			State any seasonal variations for the performance of live music (please read guidance note 6)		
Wed					
Thur			Non-standard timings. Where you intend to use the premises for the performance of live music at different times to those listed in the column on the left, please list (please read guidance note 7)		
Fri					
Sat					
Sun					

F

Recorded music Standard days and timings (please read guidance note 8)			Will the playing of recorded music take place indoors or outdoors or both – please tick (please read guidance note 4)	Indoors	<input type="checkbox"/>
				Outdoors	<input type="checkbox"/>
				Both	<input type="checkbox"/>
Day	Start	Finish	Please give further details here (please read guidance note 5)		
Mon					
Tue			State any seasonal variations for the playing of recorded music (please read guidance note 6)		
Wed					
Thur			Non-standard timings. Where you intend to use the premises for the playing of recorded music at different times to those listed in the column on the left, please list (please read guidance note 7)		
Fri					
Sat					
Sun					

G

Performances of dance Standard days and timings (please read guidance note 8)			Will the performance of dance take place indoors or outdoors or both – please tick (please read guidance note 4)	Indoors	<input type="checkbox"/>
Day	Start	Finish		Outdoors	<input type="checkbox"/>
				Both	<input type="checkbox"/>
Mon			Please give further details here (please read guidance note 5)		
Tue					
Wed			State any seasonal variations for the performance of dance (please read guidance note 6)		
Thur					
Fri			Non-standard timings. Where you intend to use the premises for the performance of dance at different times to those listed in the column on the left, please list (please read guidance note 7)		
Sat					
Sun					

H

Anything of a similar description to that falling within (e), (f) or (g) Standard days and timings (please read guidance note 8)			Please give a description of the type of entertainment you will be providing		
Day	Start	Finish	Will this entertainment take place indoors or outdoors or both – please tick (please read guidance note 4)	Indoors	<input type="checkbox"/>
Mon				Outdoors	<input type="checkbox"/>
				Both	<input type="checkbox"/>
Tue			Please give further details here (please read guidance note 5)		
Wed					
Thur			State any seasonal variations for entertainment of a similar description to that falling within (e), (f) or (g) (please read guidance note 6)		
Fri					
Sat			Non-standard timings. Where you intend to use the premises for the entertainment of a similar description to that falling within (e), (f) or (g) at different times to those listed in the column on the left, please list (please read guidance note 7)		
Sun					

I

Late night refreshment Standard days and timings (please read guidance note 8)			Will the provision of late night refreshment take place indoors or outdoors or both – please tick (please read guidance note 4)	Indoors	<input type="checkbox"/>
Day	Start	Finish		Outdoors	<input type="checkbox"/>
				Both	<input type="checkbox"/>
Mon			Please give further details here (please read guidance note 5)		
Tue					
Wed			State any seasonal variations for the provision of late night refreshment (please read guidance note 6)		
Thur					
Fri			Non-standard timings. Where you intend to use the premises for the provision of late night refreshment at different times, to those listed in the column on the left, please list (please read guidance note 7)		
Sat					
Sun					

J

Supply of alcohol Standard days and timings (please read guidance note 8)			Will the supply of alcohol be for consumption – please tick (please read guidance note 9)	On the premises	<input type="checkbox"/>
				Off the premises	<input checked="" type="checkbox"/>
				Both	<input type="checkbox"/>
Day	Start	Finish	State any seasonal variations for the supply of alcohol (please read guidance note 6) N/A		
Mon	08:00	03:00			
Tue	08:00	03:00			
Wed	08:00	03:00			
Thur	08:00	03:00			
Fri	08:00	03:00			
Sat	08:00	03:00			
			Non-standard timings. Where you intend to use the premises for the supply of alcohol at different times to those listed in the column on the left, please list (please read guidance note 7) N/A		
Sun	08:00	03:00			

K

Please highlight any adult entertainment or services, activities, other entertainment or matters ancillary to the use of the premises that may give rise to concern in respect of children (please read guidance note 10).

N/A

L

Hours premises are open to the public Standard days and timings (please read guidance note 8)			State any seasonal variations (please read guidance note 6) N/A
Day	Start	Finish	
Mon	08:00	03:00	
Tue	08:00	03:00	
Wed	08:00	03:00	
Thur	08:00	03:00	
Fri	08:00	03:00	
Sat	08:00	03:00	
Sun	08:00	03:00	
Non-standard timings. Where you intend the premises to be open to the public at different times from those listed in the column on the left, please list (please read guidance note 7) N/A			

Please identify those conditions currently imposed on the licence which you believe could be removed as a consequence of the proposed variation you are seeking.

N/A

Please tick as appropriate

- I have enclosed the premises licence
- I have enclosed the relevant part of the premises licence

If you have not ticked one of these boxes, please fill in reasons for not including the licence or part of it below

Reasons why I have not enclosed the premises licence or relevant part of premises licence.

M Describe any additional steps you intend to take to promote the four licensing objectives as a result of the proposed variation:

a) General – all four licensing objectives (b, c, d and e) (please read guidance note 11)

Existing conditions will remain as it is.

b) The prevention of crime and disorder

c) Public safety

d) The prevention of public nuisance

e) The protection of children from harm

--

Checklist:

Please tick to indicate agreement

- I have made or enclosed payment of the fee; or
- I have not made or enclosed payment of the fee because this application has been made in relation to the introduction of the late night levy.
- I have sent copies of this application and the plan to responsible authorities and others where applicable.
- I understand that I must now advertise my application.
- I have enclosed the premises licence or relevant part of it or explanation.
- I understand that if I do not comply with the above requirements my application will be rejected.

IT IS AN OFFENCE, UNDER SECTION 158 OF THE LICENSING ACT 2003, TO MAKE A FALSE STATEMENT IN OR IN CONNECTION WITH THIS APPLICATION. THOSE WHO MAKE A FALSE STATEMENT MAY BE LIABLE ON SUMMARY CONVICTION TO A FINE OF ANY AMOUNT.

Part 5 – Signatures (please read guidance note 12)

Signature of applicant (the current premises licence holder) or applicant's solicitor or other duly authorised agent (please read guidance note 13). **If signing on behalf of the applicant, please state in what capacity.**

Signature	
Date	14/12/2023
Capacity	Licensing Consultant

Where the premises licence is jointly held, signature of 2nd applicant (the current premises licence holder) or 2nd applicant's solicitor or other authorised agent (please read guidance note 14). **If signing on behalf of the applicant, please state in what capacity.**

Signature	
Date	
Capacity	

Contact name (where not previously given) and address for correspondence associated with this application (please read guidance note 15)

[REDACTED]

Post town

[REDACTED]

Post code

[REDACTED]

Telephone number (if any)

[REDACTED]

If you would prefer us to correspond with you by e-mail, your e-mail address (optional)

[REDACTED]

Notes for Guidance

This application cannot be used to vary the licence so as to extend the period for which the licence has effect or to vary substantially the premises to which it relates. If you wish to make that type of change to the premises licence, you should make a new premises licence application under section 17 of the Licensing Act 2003.

1. You do not have to pay a fee if the only purpose of the variation for which you are applying is to avoid becoming liable for the late night levy
2. Describe the premises. For example, the type of premises, its general situation and layout and any other information which could be relevant to the licensing objectives. Where your application includes off-supplies of alcohol and you intend to provide a place of consumption of these off-supplies of alcohol, you must include a description of where the place will be and its proximity to the premises.
3. In terms of specific regulated entertainments please note that:
 - Plays: no licence is required for performances between 08.00 and 23.00 on any day, provided that the audience does not exceed 500.
 - Films: no licence is required for 'not-for-profit' film exhibition held in community premises between 08.00 and 23.00 on any day provided that the audience does not exceed 500 and the organiser (a) gets consent to the screening from a person who is responsible for the premises; and (b) ensures that each such screening abides by age classification ratings.
 - Indoor sporting events: no licence is required for performances between 08.00 and 23.00 on any day, provided that the audience does not exceed 1000.
 - Boxing or Wrestling Entertainment: no licence is required for a contest, exhibition or display of Greco-Roman wrestling, or freestyle wrestling between 08.00 and 23.00 on any day, provided that the audience does not exceed 1000. Combined fighting sports – defined as a contest, exhibition or display which combines boxing or wrestling with one or more martial arts – are licensable as a boxing or wrestling entertainment rather than an indoor sporting event.
 - Live music: no licence permission is required for:

APPENDIX B1

RESPONSIBLE AUTHORITY REPRESENTATION: APPLICATION UNDER THE LICENSING ACT 2003

RESPONSIBLE AUTHORITY DETAILS

NAME OF AUTHORITY	Metropolitan Police service
ADDRESS OF AUTHORITY	Licensing Unit, Stoke Police Station 33 Stoke Newington High Street London N16 8DS
CONTACT NAME	PC 3288CE Amanda GRIGGS
TELEPHONE NUMBER	07884 561085
E-MAIL ADDRESS	hackneylicensing@met.police.uk

APPLICATION PREMISES

NAME & ADDRESS OF PREMISES	Dalston Corner 1 Stoke Newington Road London N16 8BH
NAME OF PREMISES USER	Mehmet Annak

COMMENTS

I make the following relevant representations in relation to the above application to vary the Premises Licence at the above address.

- 1) the prevention of crime and disorder
- 2) public safety
- 3) the prevention of public nuisance
- 4) the protection of children from harm

Representations (which include comments and/or objections) in relation to:

Police make the following representations in relation to the application to vary the Premises Licence at Dalston Corner, 1 Stoke Newington Road, N16 8BH for the following reason(s);

The application wishes to extend the sale of alcohol to 0300hrs throughout the week. The premises only applied for its current licence in June 2023 with a sub-committee hearing taking place on 17th August granting the licence with some additional conditions and at core hours as applied for.

The venue applied for some TENS to open until 0300hrs over the weekends leading up to Christmas. During this time police were made aware that there had been sales of alcohol after this 0300hrs time. One of these was on 9th December at 0322hrs and was for a bottle of Jack Daniels at a cost of £21.99, and a second on 10th December at 0313hrs with a receipt saying alcohol to a total of £6.29.

Police are aware that a warning letter was delivered to them by the Local Authority. As a result of these sales, police visited on 15th December 2023 and found a multitude of licence breaches. The DPS and PLH was working and said he had no other staff just himself running the venue. He did not have a copy of his premises licence, and the summary was not displayed. He appeared to be unaware of many of the conditions that were on it. We asked to look at the CCTV in order to view these sales and see if there were any others, however the CCTV times and dates were not synced and the PLH/DPS had to phone someone to find out how to view the cameras to start with. He was told that the breaches would be recorded and that he needed to contact his agent to get the copy of his licence and ensure that he was familiar with the conditions and adhered to them all.

Police were then made aware that at 0315hrs on 16th December another purchase was made of a bottle of Budweiser to a council enforcement officer. She was also informed that he was allowed to sell alcohol until 0300hrs (which he was on some days as he had TENS) and until 0500hrs at Christmas – which he wasn't.

Police have attempted to revisit to carry out another licensing check however the premises has been closed during the day.

Police therefore ask that the variation be refused as the venue has barely been open a few months and already there are multiple breaches of the licence as well as sales after hours showing a complete disregard for the licence issued and the conditions attached to it.

The above representations are supported by the following evidence and information.

Personal knowledge of the local area and issues in the area, information passed by the Local Authority

Are there any actions or measures that could be taken to allay concerns or objections? If so, please explain.

None

Signed

PC 3288CE GRIGGS

(By E-mail)

Name (printed)

Representations (which include comments and/or objections) in relation to:

I write to make a representation in response to this application to vary the existing premises licence.

The premises is located in a very prominent position with much of the main frontage consisting of displays of products containing alcohol. I am concerned that the proposed additional hours for the supply of alcohol would have a negative impact on the promotion of the licensing objectives given the characteristics of the area and the availability of alcohol at low cost. In particular, the prevention of crime and disorder and the prevention of public nuisance would most likely be undermined.

A recently commissioned study found that negative cumulative impact remains a problem in the Dalston area. The availability of alcohol via off-sales late into the night has the potential to exacerbate problems. As a result, the Council's Statement of Licensing Policy states:

LP4 'Off' Sales of Alcohol

Hours for the supply of alcohol will generally be restricted to between 08:00 and 23:00.

The above representations are supported by the following evidence and information.

The Licensing Act 2003, guidance issued by the Home Office under s182 of the Licensing Act 2003

Are there any actions or measures that could be taken to allay concerns or objections? If so, please explain.

N/A

Name: **David Tuitt (Business Regulation Team Leader) - Licensing and Technical Support**

11th January 2024

RE: Dalston Corner 1 Stoke Newington Road London N16 8BH

1 message

10 January 2024 at 15:18

[REDACTED]
to: "licensing@hackney.gov.uk" <licensing@hackney.gov.uk>

Dear Licensing,

RE: Dalston Corner

1 Stoke Newington Road

London N16 8BH

Mr Annak Application for variation of premises licence to extend supply of alcohol till 03:00am Mon to Sun. 11/01/2024

It would be irresponsible to not refuse this application which would increase crime and nuisance as well as add to the impact of other premises in the area.

Regards,

[REDACTED]



**RE: LSC-22 February 2024: Application to vary a premises licence - Dalston
Corner, 1 Stoke Newington Road, Hackney, London, N16 8BH**

1 message

7 February 2024 at 11:59

[REDACTED]
To: "Licensing (Shared Mailbox)" <licensing@hackney.gov.uk>

Dear Licensing,

Please include the following images in the report.

Regards,

[REDACTED]

Corner OFF LICENCE



Corner OFF LICENCE

KORAY GENTS HAIR SALON OPEN

AL BARNA



ALL OF US MORE OF US

01/02/2024 13:08



22/01/2024 14:43



This premises licence has been issued by:

Licensing Service
1 Hillman Street
London E8 1DY

PART A – PREMISES LICENCE

Premises Licence Number

PREM/2023/0046

Part 1 – Premises details

Dalston Corner
1 Stoke Newington Road
Hackney
London
N16 8BH

Where the licence is time limited the dates

Not Applicable

Licensable activities authorised by the licence

Supply of Alcohol

The times the licence authorises the carrying out of Licensable activities

Supply of Alcohol	Standard Hours: Mon 08:00-23:00 Tue 08:00-23:00 Wed 08:00-23:00 Thu 08:00-23:00 Fri 08:00-23:00 Sat 08:00-23:00 Sun 08:00-23:00
The opening hours of the premises	Standard Hours: Mon 08:00-23:00 Tue 08:00-23:00 Wed 08:00-23:00 Thu 08:00-23:00 Fri 08:00-23:00 Sat 08:00-23:00 Sun 08:00-23:00

Where the licence authorises supplies of alcohol whether these are on and/or off supplies

Off Premises

Part 2 –

Name, (registered) address, telephone number and e-mail (where relevant) of holder of premises licence

Mehmet Annak

[REDACTED]
[REDACTED]
[REDACTED]
[REDACTED]

Registered number of holder, for example company number, charity number (where applicable)

Not Applicable

Name, address and telephone number of designated premises supervisor where the premises authorises the supply of alcohol

Mehmet Annak

[REDACTED]
[REDACTED]
[REDACTED]
[REDACTED]

Personal licence number and issuing authority of personal licence held by designated premises supervisor where the premises licence authorises the supply of alcohol

Licence No: [REDACTED]
Issuing Authority: [REDACTED]

Date of Grant: 17 August 2023

Signed:

[REDACTED]

Gerry McCarthy
Head of Community Safety, Enforcement and Business Regulation

Annex 1 - Mandatory Conditions

Supply Of Alcohol(Off)

Supply of Alcohol

1. No supply of alcohol may be made under the premises licence:
 - (a) At a time when there is no designated premises supervisor in respect of the premises licence.
 - (b) At a time when the designated premises supervisor does not hold a personal licence or his personal licence is suspended.
2. Every supply of alcohol under the premises licence must be made or authorised by a person who holds a personal licence.
3.
 - 3.1. The premises licence holder or club premises certificate holder must ensure that an age verification policy is adopted in respect of the premises in relation to the sales or supply of alcohol.
 - 3.2 The designated premises supervisor in relation to the premises licences must ensure that the supply of alcohol at the premises is carried on in accordance with the age verification policy.
 - 3.3. The policy must require individuals who appear to the responsible person to be under 18 years of age (or such older age as may be specified in the policy) to produce on request, before being served alcohol, identification bearing their photograph, date of birth and either:-
 - (a) a holographic mark or
 - (b) an ultraviolet feature.

Minimum Drinks Pricing

4.
 - 4.1 A relevant person shall ensure that no alcohol is sold or supplied for consumption on or off the premises for a price which is less than the permitted price.
 - 4.2 For the purposes of the condition set out in paragraph 4.1 above -
 - (a) “duty” is to be construed in accordance with the Alcoholic Liquor Duties Act 1979;
 - (b) “permitted price” is the price found by applying the formula - $P = D + (D \times V)$
Where -
 - (i) P is the permitted price,
 - (ii) D is the rate of duty chargeable in relation to the alcohol as if the duty were charged on the date of the sale or supply of the alcohol, and
 - (iii) V is the rate of value added tax chargeable in relation to the alcohol as if the value added tax were charged on the date of the sale or supply of the alcohol;
 - (c) “relevant person” means, in relation to premises in respect of which there is in force a premises licence -
 - (i) the holder of the premises licence,
 - (ii) the designated premises supervisor (if any) in respect of such a licence, or
 - (iii) the personal licence holder who makes or authorises a supply of alcohol under such a licence;
 - (d) “relevant person” means, in relation to premises in respect of

which there is in force a club premises certificate, any member or officer of the club present on the premises in a capacity which enables the member or officer to prevent the supply in question; and
(e) "value added tax" means value added tax charged in accordance with the Value Added Tax Act 1994.

4.3 Where the permitted price given by Paragraph 4.2(b) above would (apart from this paragraph) not be a whole number of pennies, the price given by that sub-paragraph shall be taken to be the price actually given by that sub-paragraph rounded up to the nearest penny.

4.4 (1) Sub-paragraph 4.4(2) below applies where the permitted price given by Paragraph 4.2(b) above on a day ("the first day") would be different from the permitted price on the next day ("the second day") as a result of a change to the rate of duty or value added tax.

(2) The permitted price which would apply on the first day applies to sales or supplies of alcohol which take place before the expiry of the period of 14 days beginning on the second day.

Annex 2 – Conditions consistent with the Operating Schedule

5. The DPS, a personal licence holder or trained member of staff nominated in writing by the DPS shall be on duty at all times the premises are open to the public.
6.
 - a) A CCTV system covering the interior & exterior of the premises will be installed to current metropolitan police / Home office standards and shall be kept operational at all times the premises are open to the public.
 - b) It shall be capable of taking a head & shoulders shot of persons entering the premises, of recording images to an evidential standard in any light and be capable of storing images for a minimum of 31 days.
 - c) All staff who may work front of house shall be trained to operate the CCTV system and download images.
 - d) At least one member of staff trained to operate the CCTV system & download images shall be on duty at all times the premises are open to the public. Footage shall be shown to the police and screenshots provided to them on request. Copies of downloaded images shall be provided to the police on a USB stick, CD or other acceptable means as soon as possible and in any case within 24 hours of the request.
7. An incident book shall be kept at the premises, and made available to the police or authorised council officers, which will record the following:
 - a) All crimes reported
 - b) Lost property
 - c) All ejections of customers
 - d) Any complaints received
 - e) Any incidents of disorder
 - f) Any seizure of drugs or offensive weapons
 - g) Any faults in the CCTV
 - h) Any refusal in the sale of alcohol
 - i) Any visit by a relevant authority or emergency service.
8. Notices will be prominently displayed by the entry/ exit door and point of sale (as appropriate) advising customers:
 - a) That CCTV & Challenge 25 are in operation
 - b) Advising customers of the provisions of the licensing act regarding underage & proxy sales
 - c) Of the permitted hours for licensable activities & the opening times of the premises
 - d) Not to drink in the street
 - e) To respect residents, leave quietly, not to loiter outside the premises or in the vicinity and to dispose of litter legally.
9. No beers, lagers or ciders in single cans, bottles or multi-packs with an ABV of more than 6.5% will be displayed, sold or offered for sale from the premises. This condition does not apply to Guinness Foreign (ABV 7.5%), Dragon Stout (ABV 7.5%) and Leffe Blonde (ABV 6.6%).

10. The front of the premises shall be kept tidy at all times and be swept at close.
11. Relevant notices will be prominently displayed by the entry/ exit door and point of sale (as appropriate).
12. No deliveries will be received or rubbish removed from the premises between 22.00 & 07.00.
13. Any music played will only be played at background level.
14. A phone number for the premises shall be made available if required upon request to the police, any other responsible authority or any local resident to express any concerns caused by the operation of the premises. Any complaints and the outcome will be recorded in the incident book.
15. Challenge 25 shall be operated as the proof of age policy and only a valid passport, photo driving licence, HM forces photographic id card or proof of age card with the pass logo or hologram on it may be accepted as proof of age.
16. All staff who work front of house will be trained for their role on induction and be given refresher training every six months. Written training records will be kept for each staff member and be produced to police & authorised council officers on request. Training will include identifying persons Under 25, making a challenge, acceptable proof of age & checking it, making & recording a refusal, avoiding conflict & responsible alcohol retailing.

Annex 3 – Conditions attached after a hearing by the licensing authority

17. No licensable activities are permitted at the front and rear of the premises.
18. The Licence holder will display signage prominently requesting customers leave the proximity of the shop quickly and quietly respecting any local residents.
19. The front of the premises will be monitored at busy times after 18:00 to ensure large groups of customers do not congregate at the busy junction and potentially dangerous crossings which is a risk to public safety.
20. The garden area shall not be used for licensable activities and there shall be regular litter checks and collection of litter in the area.
21. The Licensee shall ensure that all staff are fully trained and made aware of the legal requirement of businesses to comply with their duty of care as regards the disposal of waste produced from the business premises. During the hours of operation of the premises, the licence holder shall ensure sufficient measures are in place to remove and prevent litter or waste arising or accumulating from customers in the area immediately outside the premises, and that this area shall be swept and or washed, and litter and sweepings collected and stored in accordance with the approved refuse storage arrangements by close of business.
22. No deliveries to the premises shall take place between 23:00 and 08:00 on the following day.
23. The procedure for handling and preparing for disposal of the waste shall be in writing and displayed in a prominent place where it can be referred to at all times by staff.
24. The Licensee shall ensure that any contract for general and recyclable waste disposal shall be appropriate in size to the amount of waste produced by the business. The Licensee shall maintain an adequate supply of waste receptacles provided by his registered waste carrier (refuse sacks or commercial waste bins) in order to ensure all refuse emanating from the business is always presented for collection by his waste carrier and shall not use any plain black or unidentifiable refuse sacks or any other unidentifiable or unmarked waste receptacles.
25. In order to minimise the amount of time any waste remains on the public highway in readiness for collection, the Licensee will ensure the timeframe within which it may expect its waste carrier to collect is adhered to. The Licensee must ensure he/she complies with any orders or notices served by the Council.
26. The Licensee shall erect a sign asking customers to refrain from littering the public highway outside the premises and will also instruct members of staff to make regular checks of the area immediately outside and within 10 metres either side of the premises and remove any litter, bottles and glasses emanating from the premises. A final check should be made at close of business.

Annex 4 – Plans

PLAN/PREM/2023/0046/070623

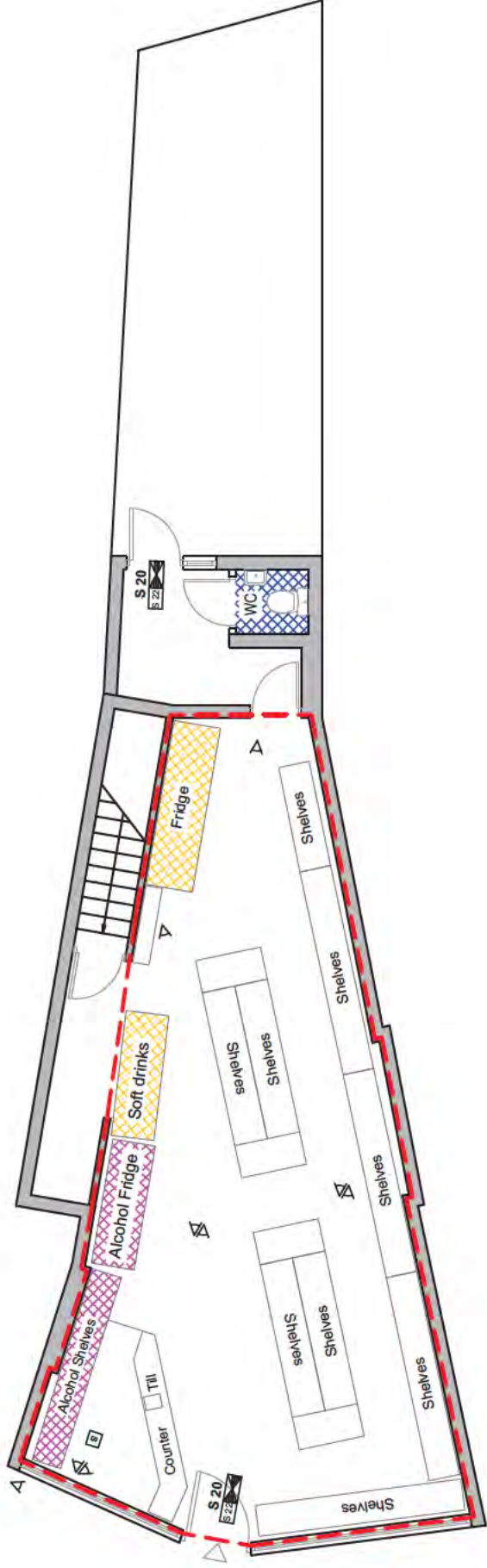

GROUND FLOOR PLAN

LEGEND

-  ALCOHOL
-  WC AREA
-  FRIDGES
-  AMBIT OF LICENSED PREMISES
-  SAFETY LIGHTS
-  SMOKE DETECTOR
-  CCTV
-  S 20 FIRE ESCAPE KEEP CLEAR
-  INTERNALLY ILLUMINATED FIRE ESCAPE SIGN (BS 5266)



NARTS   /nartsbritain

Voice of Turkish & Kurdish Food Industry in Britain

53 Stoke Newington High Street, London N16 8EL
 Tel: 020 7241 3636 | Mob: 07940 414 890 | www.narts.org.uk | info@narts.org.uk

GENERAL NOTES:
 Copyright© Narts Architecture is the subject of Intellectual Property Rights. All copyright and design right and shall not be reproduced, copied, loaned or submitted to other party without the written consent of Narts Architecture.

ADDRESS: **1 Stoke Newington Rd,
 London N16 8BH**

DRAWING NAME: **Ground Floor Plan**

DRAWING DATE	07/06/2023	TOTAL AREA	ADD
SCALE:	1:100 @A4	SHEET:	1
DRAWN BY:	OZ	CONTROL BY:	MHR

APPENDIX E

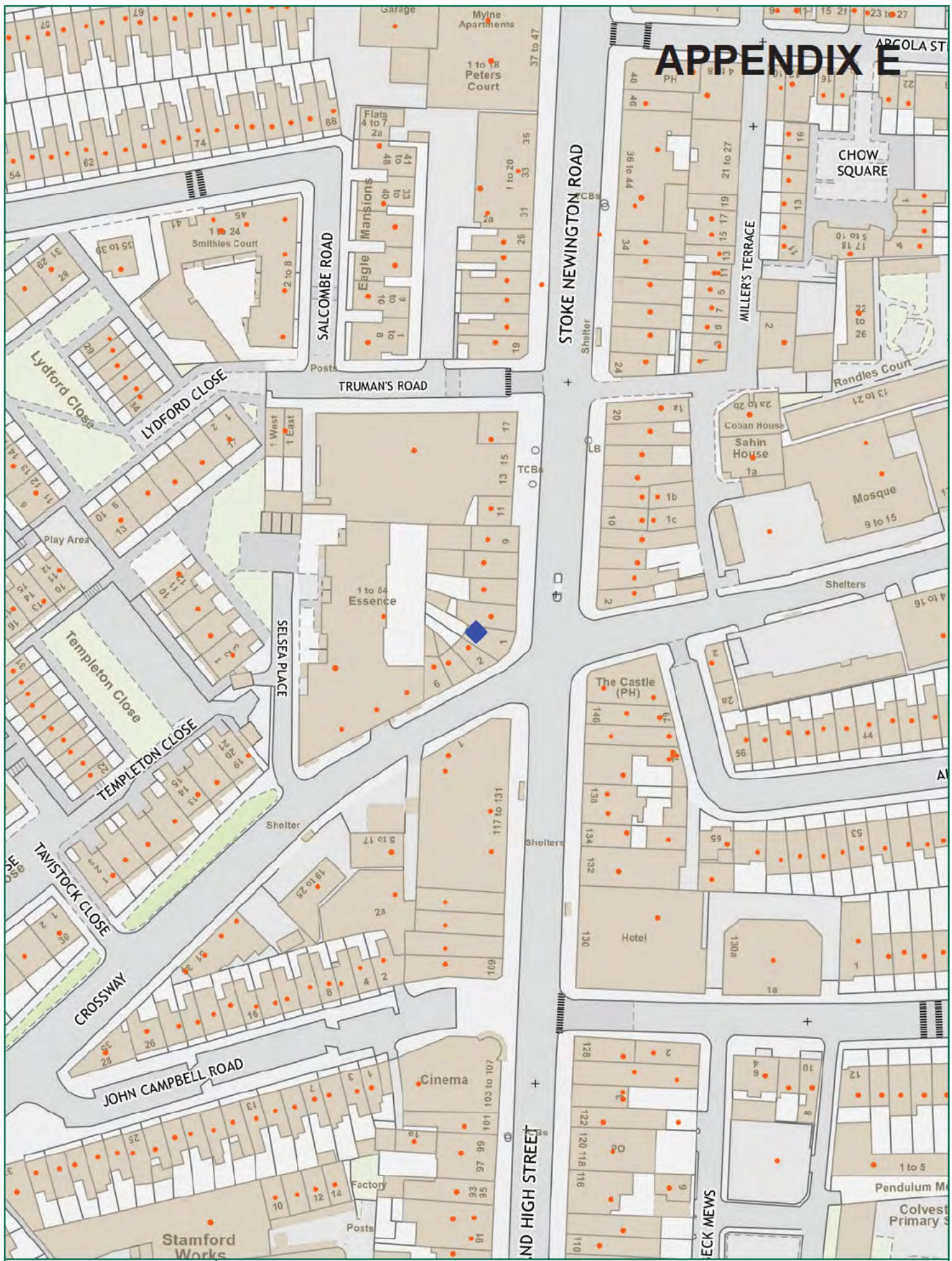

 NORTH

Scale: 1:1250 at A4

 Hackney

Dalston Corner, 1 Stoke Newington Road, N16 8BH

Ref:	Produced by: unspecified	please specify copyright statement
Monday, August 7, 2023	email:	